



# 20L DEHUMIDIFIER

\*Please refer to the warranty section for terms of your extended guarantee



## Page No.

2	Contents
3	Reading and Storing the User Manual
3	Important Safety Instructions for Proper Use
7	Explanation of Symbols
8	Before First Use of Your Dehumidifier
8	Installing the Hepa Filter
9	Description of Parts
10	Description of Parts – The Control Panel
10	Installing Your Dehumidifier
11	Using Your Dehumidifier
11	Powering Up
11	Selecting Modes – Dehumidifier/Laundry/Fan
12	Swing/Oscillate
12	Setting the Humidity Level
12	Using the Timer
13	Child Lock
13	Defrost
13	Water Tank Full Alarm/ Emptying the Water Tank
15	Continuous Drainage
16	Cleaning and Replacing the Hepa Filter
16	Replacement Hepa Filters
16	Storage
16	Care and Maintenance of Your Dehumidifier
17	Technical Specification
17	Plug Wiring Information
18	Recycling Information
18	Troubleshooting Guide
19	Customer Support
Back Page	Warranty Information

## READING AND STORING THE USER MANUAL



Before using this product, please read through this manual carefully paying particular attention to the safety instructions. Failure to do so may result in personal injury or damage to the product.

Carefully save this instruction manual for future reference. Ensure the user manual is included when passing the product on to any third parties.

## IMPORTANT SAFETY INSTRUCTIONS FOR PROPER USE

**When using electrical appliances, basic safety precautions should always be followed.**

Only use the product as described in this user manual. Any other use is considered improper and may result in damage to property or persons. The manufacturer or vendor cannot be held liable for damages or injury incurred through improper or incorrect use.

- **Read and familiarise yourself with all operating instructions before using this Dehumidifier.**
- Before using your unit into the mains, visually check that the unit is intact and has not suffered any transit damage.
- Check that the voltage indicated on the data plate corresponds with that of the local network before connecting the appliance to the mains power supply.
- Always use this appliance on a solid, level, non-flammable surface.
- The Dehumidifier shall not be exposed to dripping or splashing and that no objects filled with liquids, such as vases, shall be placed on the apparatus.
- **DO NOT** immerse the Dehumidifier or its power cord in water or any other liquids.
- **DO NOT** leave the Dehumidifier unattended during use.
- **DO NOT** leave the Dehumidifier unattended whilst connected to a mains power supply.
- Avoid touching any moving parts within the appliance.
- **DO NOT** insert fingers, pencils or any other objects through the guard.

- **DO NOT** push objects into any openings as damage to the product and/or electric shock may occur.
- This appliance can be used by children aged from 8 years and above and persons with reduced physical, sensory or mental capabilities or lack of experience and knowledge if they have been given supervision or instruction concerning use of the appliance in a safe way and understand the hazards involved. Children shall not play with the appliance. Cleaning and user maintenance shall not be made by children without supervision.
- Children of less than 3 years should be kept away unless continuously supervised.
- Close supervision is required when using this Dehumidifier near children.
- **DO NOT** leave this Dehumidifier within reach of children.
- It is imperative to unplug from mains supply after the Dehumidifier has been used, before it is cleaned and whilst being repaired.
- Unplug after each use.
- **DO NOT** operate this appliance if the power cord or plug are damaged. Ensure that the power cord is not stretched or exposed to sharp objects or edges.
- **DO NOT** operate this appliance after a malfunction or after being dropped or damaged in any way.
- **DO NOT** allow the mains cable to hang over sharp edges or come in contact with hot surfaces.
- **DO NOT** run the mains cable under carpets, rugs, etc.
- Individuals who operate or work in the refrigerant circuit must have the appropriate certification issued by an accredited organization that ensure competence in handling refrigerants according to a specific evaluation recognized by associations in the industry.
- Repairs must be performed on the recommendation from the manufacturing company. Maintenance and repairs that require the assistance of other qualified persons must

be performed under the supervision of an individual specified in the use of flammable refrigerants.

- This product is intended for household use only and should not be used for industrial purposes.
- **DO NOT** connect the appliance to an electrical outlet using an extension lead. If an outlet is not available, one should be installed by a qualified electrician.
- **DO NOT** use the mains plug or external timer as a means of switching the Dehumidifier on or off. Use the ON/OFF button located on the control panel.
- Always place the unit on a dry and stable surface.
- The appliance should not be placed in a Bathroom or Wet room.
- **DO NOT** position the Dehumidifier close to sources of heat and/or ignition such as radiators, heaters, other electronic equipment, etc.
- No naked flame sources, such as lighted candles, should be placed on the Dehumidifier.
- The appliance must be installed and used in a room with a floor area larger than 4m<sup>2</sup>.
- This appliance contains R290 refrigerant gas. For quantity see rating label on rear of the unit.
- R290 refrigerant gas complies with the EU environmental directives.
- Refrigerant gas may be odourless, if the appliance is used or stored in an unventilated room, the room must be as such to prevent stagnation of possible leaks of refrigerant gas as there could be a danger of fire or explosion hazard should the refrigerant come into contact with electric heaters, stoves or other sources of ignition.
- The refrigerant system should not be perforated.
- The appliance must be stored in such a way as to prevent mechanical failure.
- **DO NOT** use any accessories or attachments with this product other than those supplied or recommended by

the supplier.

- **DO NOT** use this product for anything other than its intended use.
- The Dehumidifier must always be stored and transported upright, otherwise irreparable damage be caused to the compressor; if in doubt, wait at least 24 hours before restarting the unit.
- Avoid restarting the Dehumidifier unless 3 minutes have passed since being turned off. This prevents damage to the compressor.

### Explanation of Symbols

The following warning symbols or words are used in this instruction manual:



Products labelled with UK Conformity Assessment identifies products conforming to UK statutory requirements.



Products labelled with this symbol conform to applicable provisions of the European Economic Area.



This symbol provides useful additional information on the use of this product.



This symbol identifies that the supply uses an alternating current mains supply.

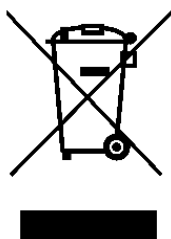

You should now recycle your waste electrical goods and in doing so help the environment. This symbol means waste electrical products at the end of their useful life should not be disposed of with normal household waste and not sent to landfill. Please ensure it is taken to a suitable facility for disposal. Check with your Local Authority or retailer for recycling advice or visit [www.recycle-more.co.uk](http://www.recycle-more.co.uk) enter your postcode to find out your nearest recycling site.



These symbols indicate the presence of flammable materials, in this instance R290 Refrigerant Gas.





**Before First Use of Your Dehumidifier**

Remove all packing materials and discard responsibly.

**Installing the Hepa Filter**

Before using your Dehumidifier, the **Hepa Filter (9)** must first be installed as follows:

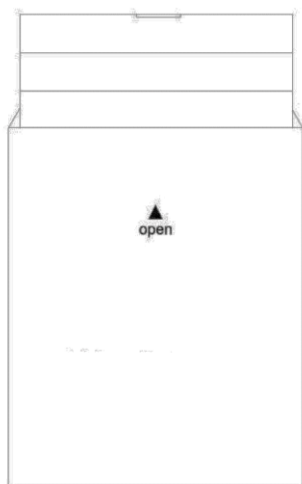

1. Remove the **Hepa Filter (9)** from the paper bag:

2. Remove the **Air Filter Cover (8)** by pulling the **Air Filter Cover Pull (7)** as shown right:

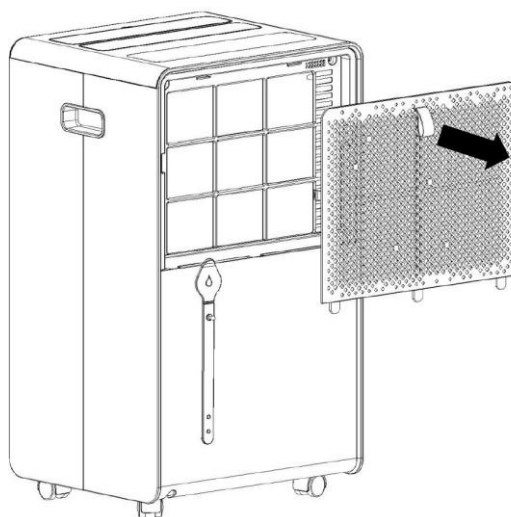

3. Insert the **Hepa Filter (9)** behind the **Air Filter Cover (8)** and replace the cover:

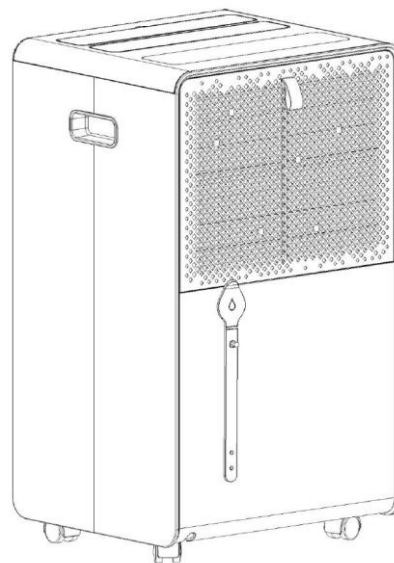
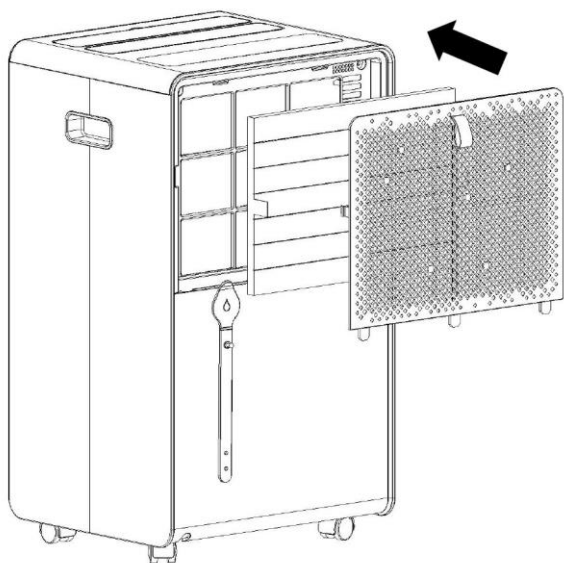



Ensure all parts are present – see **Description of Parts** below.

### Description of Parts

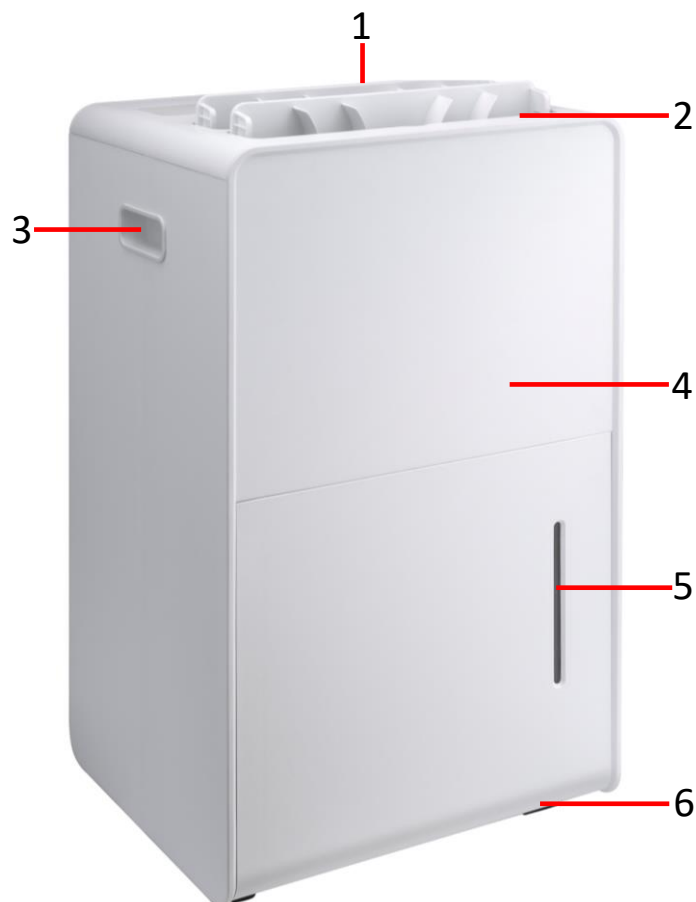

- 1. Control Panel
- 2. Air Outlet Louvres
- 3. Handle
- 4. Main Body
- 5. Water Tank (with window)
- 6. Castors (x4)
- 7. Air Filter Cover Pull
- 8. Air Filter Cover
- 9. Hepa Filter (behind cover)
- 10. Continuous Drain Outlet/Cable Tidy
- 11. Mains Cable
- 12. Drain Hose

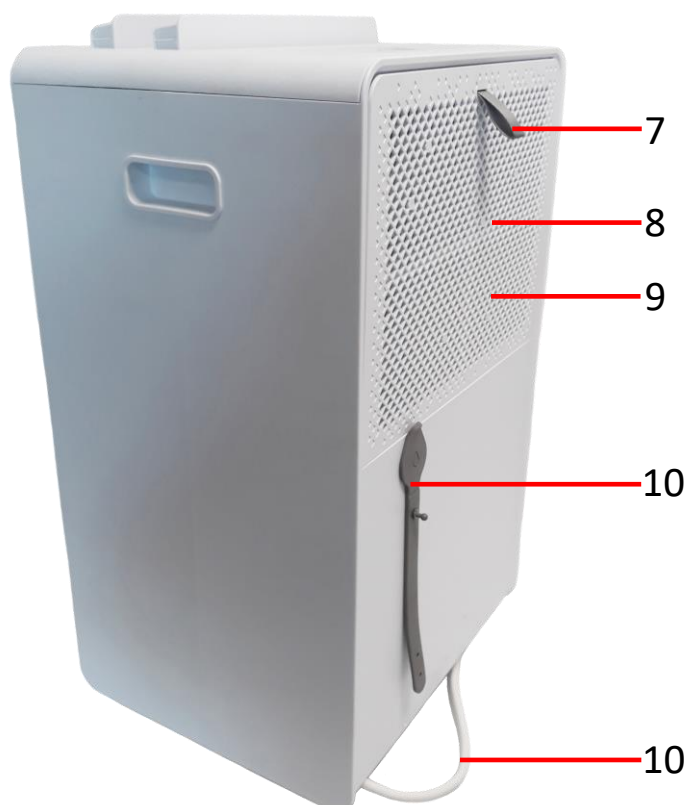

## Description of Parts – The Control Panel

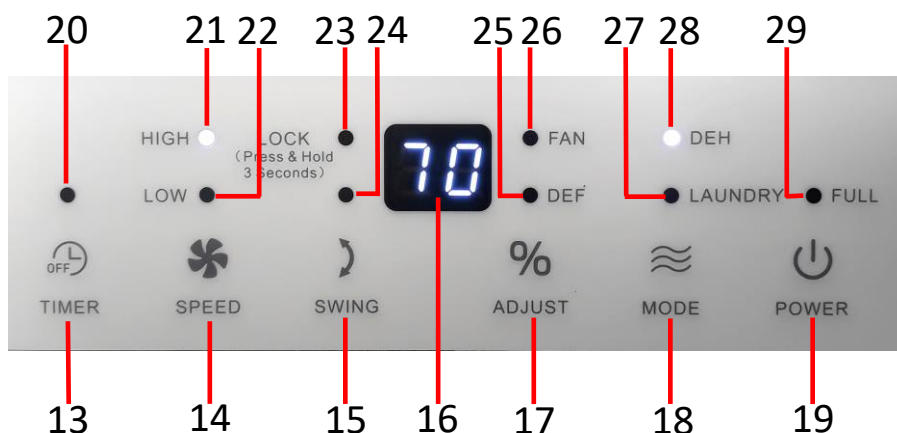

- 13. Timer Button
- 14. Speed Button
- 15. Swing (Oscillate) Button
- 16. LED Display
- 17. Humidity Set Button
- 18. Mode Button
- 19. Power Button
- 20. Timer Indicator
- 21. High Fan Speed Indicator
- 22. Low Fan Speed Indicator
- 23. Child Lock Indicator
- 24. Swing Indicator
- 25. Defrost Indicator
- 26. Fan Mode Indicator
- 27. Laundry Mode Indicator
- 28. Dehumidify Mode Indicator
- 29. Water Tank Full Indicator

## Installing Your Dehumidifier

- Place the unit on a firm, level surface in an area with at least 20cm of free space on all sides to allow for proper air circulation – see below:
- Ensure the **Hepa Filter** (9) is correctly installed as described above. DO NOT use your dehumidifier without installing the filter.
- Never install the unit where it could be subject to:
  1. Heat sources such as radiators, stoves or other products that produce heat.
  2. In an area where oil or water may be splashed.
  3. Direct sunlight.
  4. Mechanical vibration or shock.
  5. Excessive dust.
  6. Lack of ventilation, such as cabinet or bookcase.
  7. An uneven surface.



## Using Your Dehumidifier

- Insert the mains plug into the nearest available socket.

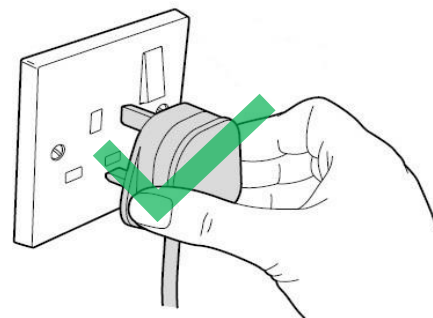

## Powering Up

- Press the **Power Button** (19) to power the unit up.
- The Dehumidifier will power up in Dehumidifier mode.
- The **LED Display** (16) will show the current humidity level.
- The **Dehumidifying Mode Indicator** (28) (DEH) will illuminate and the **Air Outlet Louvers** (1) will open. The **High** or **Low Fan Speed Indicator** (21&22) will illuminate accordingly (to whichever fan speed was selected previously).
- Press the **Power Button** (19) again to turn the unit off, the compressor will stop immediately and the fan will shut down after a 30 second delay.



## Selecting Modes

There are 3 modes to select from, press the **Mode Button** (18) to select from:

### 1. Dehumidify Mode - DEH

Press the **Mode** (18) button until the **Dehumidifying Mode Indicator** (28) (DEH) illuminates.

- If the "Co" (Continuous) dehumidification is selected, the dehumidifier will continue to run (compressor and fan) regardless of the humidity level.
- If the humidity is higher than or equal to 3% of the set humidity, the compressor and fan will run in dehumidify mode.
- Once the humidity drops below 2% of the set humidity, the compressor will stop dehumidifying and the fan will stop after 3 minutes.

### 2. Laundry Mode - LAUNDRY

Press the **Mode** (18) button until the **Laundry Indicator** (27) (LAUNDRY) illuminates. In this mode, the Dehumidifier will run continuously and the humidity setting cannot be adjusted.

### 3. Fan Only Mode - FAN

Press the **Speed Button** (21) to select the airflow speed:

- Low Fan Speed – the **Low Fan Speed Indicator** (22) (LOW) will illuminate.
- High Fan Speed – the **High Fan Speed Indicator** (21) (HIGH) will illuminate.

### Swing (Oscillate)

Press the **Swing (Oscillate)** button (15) (SWING) to enable the Swing/Oscillate Mode which enables the **Air Outlet Louvres** (1) to move back and forth to disperse air over a larger area.

Press the **Swing (Oscillate)** button (15) (SWING) to cancel the Swing/Oscillate Mode.

### Setting the Humidity Level - % ADJUST

- Press the **Humidity Set Button** (17) (% ADJUST) to set the desired humidity level which will be shown on the **LED Display** (16).
- Each press of the **Humidity Set Button** (17) will show a range of target humidity settings: Co, 30%, 35%, 40%, 45%, 50%, 55%, 60%, 65%, 70%, 75%, 80%, 85%, 90%, Co. where 'Co' is Continuous running of the dehumidifier.
- After setting the desired humidity level, the **LED Display** (16) will confirm the set value for about 3 seconds and then return to show the actual current ambient humidity.
- To view the current humidity setting on the **LED Display** (16), press the **Humidity Set Button** (17) (% ADJUST) which will show for about 3 seconds and then return to show the actual current ambient humidity.

**i** In "Laundry Mode" the humidity setting cannot be changed.

### Using the Timer

- Press the **Timer Button** (13) (TIMER) to enter the timer mode.
- The timer can be set in 1 hour increments up to a maximum of 24 hours, every press of the **Timer Button** (13) will increase the timer by 1 hour, the time will be displayed on the **LED Display** (16).
- The set time on the **LED Display** (16) will show as "07" for 7 hours, etc.
- The **Timer Indicator** (20) above the **Timer Button** (13) will illuminate during the set time period. After the set time period has ended, the **Timer Indicator** (23) will go out.

**i** If the Timer is set with the unit on, the Timer will turn the Dehumidifier **off** at the end of the set time.

**i** If the Timer is set with the unit in standby mode, (i.e. with the Dehumidifier plugged in but not running), the Timer will turn the Dehumidifier **on** at the end of the set time.

- To cancel the timer, press the **Timer Button** (13) until the **LED Display** (16) returns to "00".

**Child lock - LOCK**

Press and hold the **Swing (Oscillate)** button (15) (SWING) for 3 seconds to turn the child lock function on.

The **Child Lock Indicator** (23) will illuminate when the lock is activated.

Press and hold the **Swing (Oscillate)** button (15) (SWING) for 3 seconds to turn the child lock function off.

**Defrost - DEF**

During use the dehumidifier will automatically defrost itself. Whilst defrosting, the compressor will stop running and the **Defrost Indicator** (25) will illuminate.

Defrosting mode will take approximately 10 minutes, after which the unit will return to a normal mode of working.

**NB** The dehumidifier will not operate in temperatures below 5°C.

**Water Tank Full Alarm - FULL**

1. When the **Water Tank** (5) is full, the **Tank Full Indicator** (29) (FULL) will illuminate, the Dehumidifier will stop running and the alarm will sound.
2. Press any button to stop the alarm. The compressor and fan will shut down and all functions will pause until the **Water Tank** (5) has been emptied and replaced.

**Emptying the Water Tank (5)**

1. Grasp the **Water Tank** (5) at the bottom edge and pull the tank out:

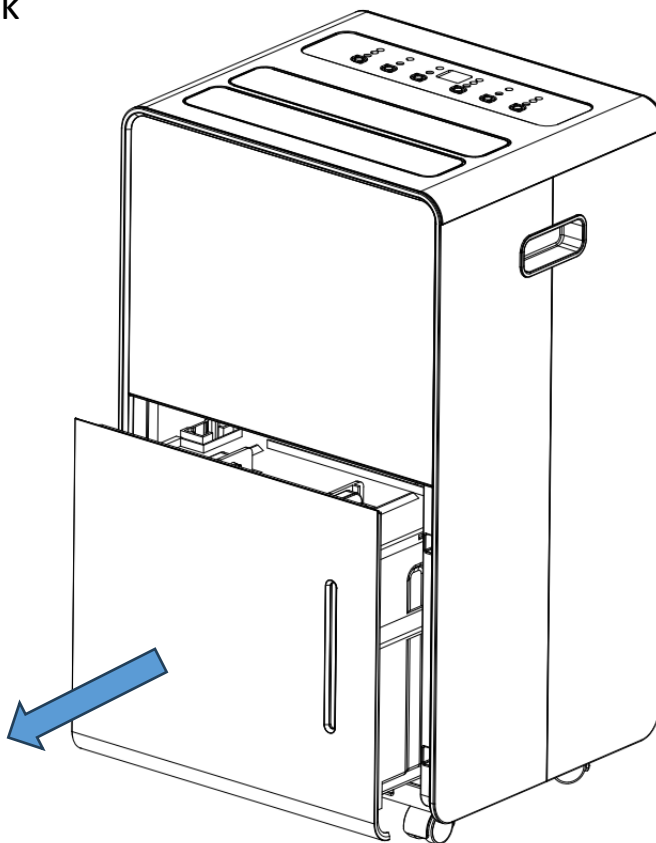

2. Lift the flap (arrowed below) at the top right rear corner of the tank lid and empty the tank:

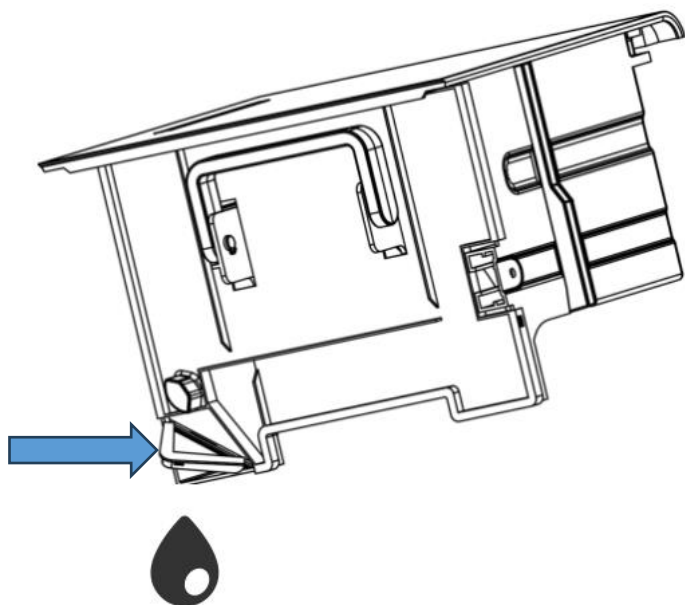

**DO NOT** remove the float from the tank otherwise the dehumidifier will not operate:

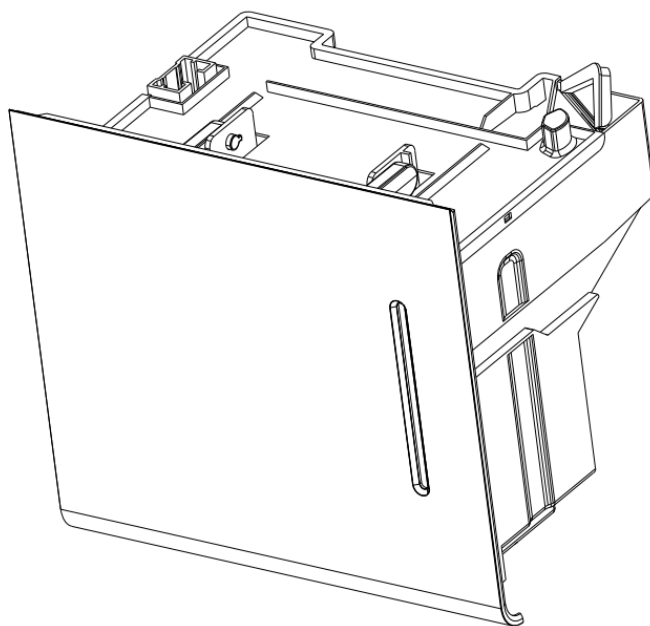

3. Close the flap at the top right rear corner and replace the **Water Tank (5)** into the Dehumidifier ensuring that it is full pushed back into place:

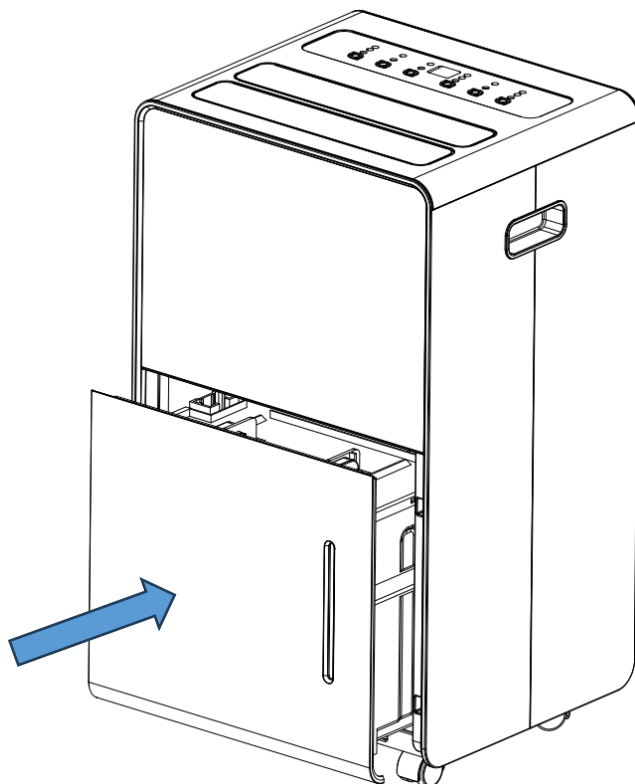

### **Continuous Drainage**

If preferred, continuous drainage can be used with the appliance rather than emptying the **Water Tank (5)**.

For this option:

- Remove the **Water Tank (5)** as described above.
- Remove the bung from the **Continuous Drain Outlet (9)** on the rear of the unit.
- Fit the **Drain Hose (11)** to the hose point on the rear of the **Main Body (4)**, arrowed right.
- Replace the **Water Tank (5)**.
- Run the hose into a suitable drainage point, ensuring that the hose is not kinked or bent and leads down away from the unit.

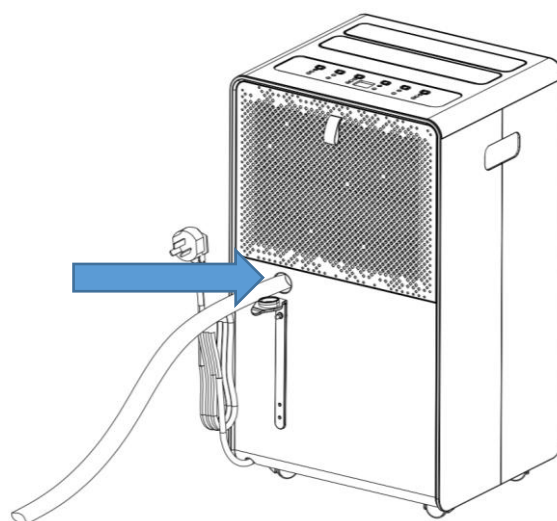



### **Cleaning and Replacing the Hepa Filter**



- Remove the **Air Filter Cover (8)** using the **Air Filter Cover Pull (7)**, remove the **Hepa Filter (9)** from behind the cover.
- To clean the **Hepa Filter (9)**, use a vacuum cleaner to remove any built up dust or lint.
- If the filter is badly soiled it can be washed in warm soapy water and a mild detergent.
- Dry thoroughly for 24 hours before refitting it to the unit.

### **Replacement Hepa Filters**

However, we recommend that the **Hepa Filter (9)** is replaced at least once a year.

Replacement Hepa filters are available by telephoning 0161 831 7879 (9.00am-5.00pm Monday-Thursday, 8.00am – 4.00pm Friday) or contacting us via email: [help@daewooelectricals.com](mailto:help@daewooelectricals.com)

### **Storage**

Whilst not in use for long periods, please ensure that you:

1. Empty the water tank and wipe away any excess moisture from the tank and body.
2. Clean the filter.
3. Place the appliance in a cool, dry environment away from direct sunlight.

### **Care and Maintenance of Your Dehumidifier**

- Always disconnect the Dehumidifier from the mains supply before cleaning.
- Do not remove the float from the water tank as this will prevent the unit from operating.
- Clean the water tank with warm soapy water, do not use harsh abrasive chemicals.
- Clean the body of the unit with a soft damp cloth.

## Technical Specification

Product Code	COL1613
Rated Voltage	220-240V ~
Rated Frequency	50Hz
Rated Current	2.3A
Rated Power	430W
Rated Capacity	20L/D (30°C, 80%RH)
Water Tank Capacity	4L
Maximum Refrigerant Charge	R290/47g
Operating Temperature Range	5°C – 35°C
Net Weight	12.5kg
Permissible Excessive Operating Pressure	Discharge 2.6MPa
	Suction 1.0MPa
Maximum Allowable Pressure	Discharge 3.2MPa
	Suction 1.2MPa
Suitable Room Size	32-40m <sup>2</sup>
Dimensions (Approx.)	500mm (h) x 290mm (w) x 250mm (d)
IP Rating	IPX0
Protection Class	I (This Appliance must be Earthed)

### Non-Rewireable Mains Plug

If your appliance is supplied with a non-rewireable plug fitted to the mains lead and should the fuse needed replacing, you must use an ASTA approved one (conforming to BS 1362 of the same rating). Never use a plug with the fuse cover missing. If in doubt, consult a qualified electrician.

If you need to remove the plug -**DISCONNECT FROM THE MAINS**- and then cut it off the mains lead and immediately dispose of it safely. Never attempt to reuse the plug or insert it into a socket outlet as there is a danger of electric shock.

## Recycling Information

### Disposal of the Packaging

Dispose of paper and cardboard in appropriate paper re-cycling facilities.

Dispose of plastics in the appropriate plastics collection service.

Dispose of non-recyclable plastics in the appropriate plastics collection service.

### Disposal of the Product

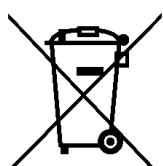

You should now recycle your waste electrical goods and in doing so help the environment. This symbol means waste electrical products at the end of their useful life should not be disposed of with normal household waste and not sent to landfill. Please ensure it is taken to a suitable facility for disposal. Check with your Local Authority or retailer for recycling advice or visit [www.recycle-more.co.uk](http://www.recycle-more.co.uk), enter your postcode to find out your nearest recycling site.

## Trouble Shooting Guide

<i>Problem</i>	<i>Possible Cause</i>	<i>Possible Solution</i>
Not working	No power	Ensure that the mains plug is inserted into a socket and the socket is switched on.
	Water Full Indicator is illuminated.	Empty the water tank
	Room temperature < 5°C, or > 35 °C	Unit will not operate below 5°C or above 35°C.
	Defrost Indicator (28) is illuminated.	The unit is defrosting, it takes around 10mins to complete. Do not unplug whilst the unit is defrosting.
Unit not performing well	Is the air filter clogged?	Clean the air filter.
	Is the air intake obstructed?	Remove the obstruction from the air intake.
No air intake	Is the filter clogged?	Clean the air filter.
Noisy when running	Ensure the unit is on a level surface.	Place the unit on a solid, level surface.
	Is the filter clogged?	Clean the air filter.
E1 code	Sensor problem.	Change the sensor/contact customer services.

## Customer Support

*Should you require any product information, replacement parts or accessories, please contact our customer care team at [help@daewooelectricals.com](mailto:help@daewooelectricals.com) or call 0161 831 7879.*

- *Replacement parts and accessories are guaranteed for 1 year from the date of purchase.*
- *It is important to note that your warranty becomes invalid should non Daewoo parts or accessories be used with this appliance*

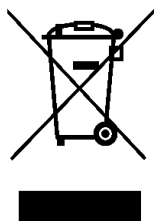
**UK  
CA**



# DAEWOO<sup>®</sup>

## WARRANTY

*Thank you for purchasing your Daewoo product.*

*As part of our commitment to quality, we are offering you an extra 2 years warranty in addition to your 1 year guarantee*

Your Daewoo product is guaranteed for 1 year from the date of original purchase, with proof of purchase or receipt. If any defect should occur due to faulty workmanship or material, your faulty product should be returned to the place of purchase, replacement or refund is at the discretion of the retailer.

The guarantee is subject to the following provisions:

- The product must be correctly installed and operated in accordance with the requirements contained in the instruction manual.
- The product must be used solely for domestic purposes.
- It does not cover general wear and tear, damage, misuse or any consumable parts.
- The guarantee will be rendered invalid if the product is re-sold or has been damaged through inexpert repair.
- The guarantee is only valid within the UK and Eire.

Your standard 1 year guarantee will only be extended to the maximum available for your individual product upon registration. (Note: products must be registered individually and covers the main body and housing). If you do not register your product within 28 days of the original purchase date, your product will only be guaranteed for 1 year.

***To validate your extended 2 year warranty\* please register your purchase online within 28 days of the original purchase date by registering at:***

***<https://help.daewooelectricals.com>***

***or***

***[Contact Us \(daewooelectricals.com\)](https://help.daewooelectricals.com)***

\*Your extended warranty is only valid with proof of purchase receipt and subject to the conditions outlined above.

Daewoo is a registered trademark.  
Produced and imported under licence by  
Eurosonic Group Limited  
Brightgate House  
1 Brightgate Way  
Manchester M32 0TB UK  
EU Rep: EuroSonic Magppie (ESM) Ltd. Ireland D05 X006  
[www.esgltd.com](http://www.esgltd.com)